



#### GENERAL DETAILS

- Rack dimensions: 50x50 cm
- Total weight: 147 Kg
- Washing cycles / racks/hour: 60"-120"-180"-9'/60-30-20-7
- Possibility of automatic start of washing cycle by closing the hood
- Upper and lower rotating wash/rinse arms with stainless steel tube
- Wash pump: 1.000 W
- Boiler capacity: 11 lt
- Tank capacity: 30 lt
- Boiler heating elements: 9 kW
- Tank heating elements: 2,8 kW
- Water quantity per cycle: 2,5 lt
- Electronic controls with LCD display
- Useful washing height: 415 mm
- Magnetic hood microswitch
- Automatic filling of water
- Double electric detergent and rinse aid dispenser
- Hot rinse
- Thermostop function
- Vertical self-cleaning washing pump
- PRS system(Atmospheric Boiler+Break tank)
- Green function for energy saving
- Self-cleaning cycle at the end of the day

#### WATER FILTRATION

- Pre-filtering of tank water by means of no. 1 stainless steel filter
- Single wash pump filter, easily removable

#### BODY

- AISI 304 stainless steel body
- Single skin hood
- Preformed wash tank with rounded corners
- Hood opening system with springs
- Removable upper and lower wash/rinse arms for easy cleaning
- Boiler in AISI 316 stainless steel

#### EQUIPMENT

- 2 racks 50x50 cm, 12/18 plates
- 1 glass rack 50x50 cm
- 2 cutlery baskets
- 1 inlet hose (2 m lenght)
- 1 drain hose (2,5 m lenght)
- 

#### OPTIONALS

- Drain pump
- Hot water filling
- Double skinned hood
- HD Version (Total power 12,8 kW, 380-415V3N~/220-240V3 ~ 50 Hz only)
- 60 Hz Version
- Kit remote control system

#### ACCESSORIES FOR WATER TREATMENT

- Integrated water softener unit ("S" model)

#### ACCESSORIES

- Entry / exit tables in stainless steel
- Pre-wash tables in stainless steel
- Special basket
- Special baskets

#### INSTALLATION

- Use the screws of the feet and a spirit level to ensure that the machine is levelled

#### MAIN POWER SUPPLY

- The voltage of main power supply must be compatible with the rated voltage
- The machine must be connected to a suitable earth (ground) system
- Connect the machine power socket to the multi-pole wall switch provided

#### WATER SUPPLY CONNECTION

- A water softener must be installed if the water is hard
- The water pressure must be between 0.2MPa (2 bar), and, 0.5MPa (5 bar)
- The temperature of the water-supply must be between 10°C to 50° C

#### TECHNICAL SPECIFICATIONS

- Voltage: **380-415V3N / 220-240V3 /220-240V~ 50 Hz**
- Total power: **10 Kw**
- Amperage: **18 A / 27 A/ 31 A**
- Power cord supply size :**5x2,5 / 3x4 mmq**

**HK 1200E PRS**

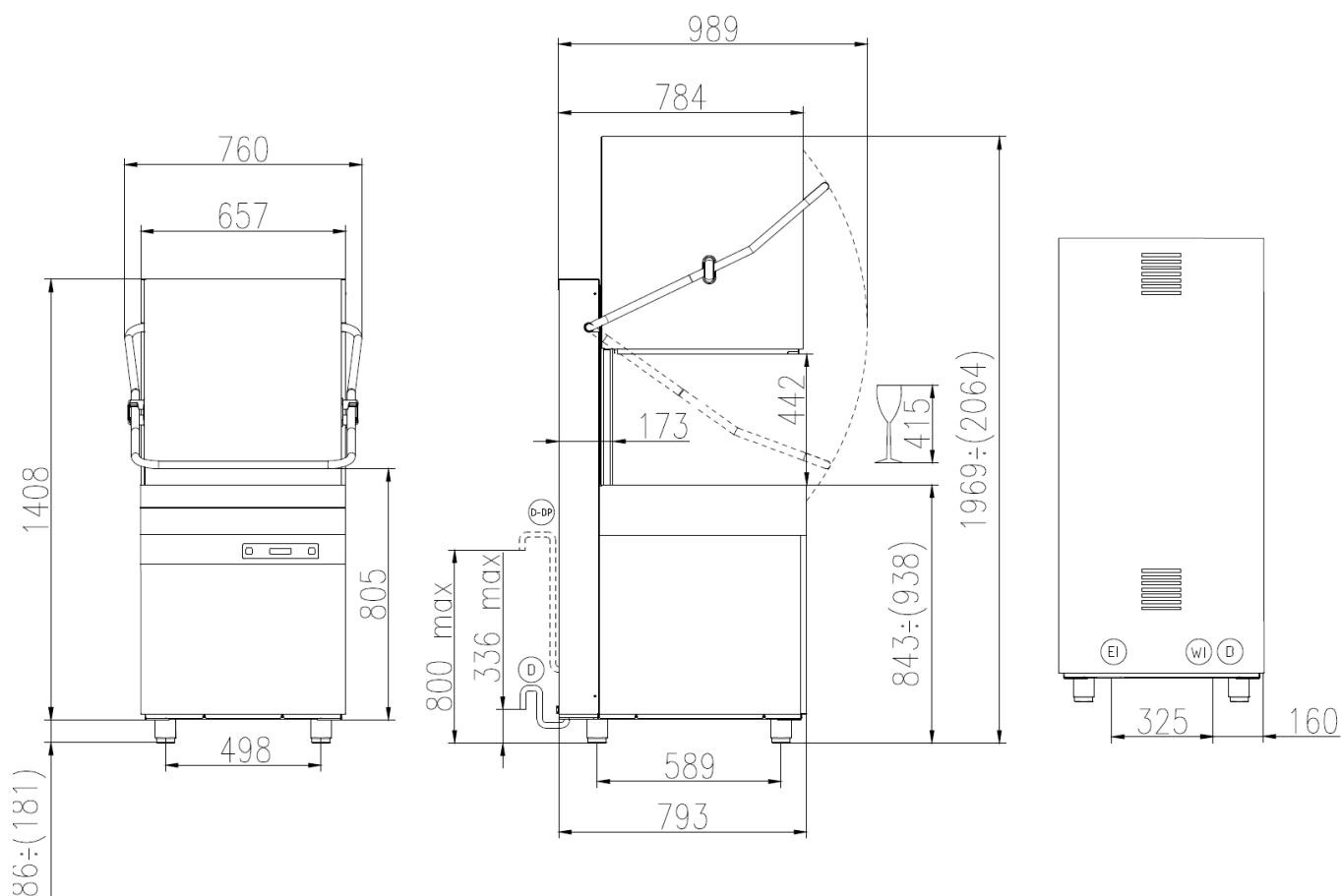

Ⓔ EI CAVO DI ALIMENTAZIONE  
POWER CORD SUPPLY  
CABLE D'ALIMENTATION  
CABLE DE ALIMENTACION

Ⓔ WI CANNA DI CARICO G 3/4" L=2000 mm  
G 3/4" INLET HOSE L=2000 mm  
TUYAU D'ALIMENTATION G 3/4" L=2000 mm  
TUBO DE ALIMENTACION G 3/4" L=2000 mm

Ⓔ D TUBO DI SCARICO Ø 40 mm L=2000 mm  
DRAIN HOSE Ø 40 mm L=2000 mm  
TUYAU DE VIDEAGE Ø 40 mm L=2000 mm  
TUBO DE DESAGUE Ø 40 mm L=2000 mm

Ⓔ D-DP TUBO DI SCARICO Ø 29 mm L=2500 mm (CON POMPA SCARICO)  
DRAIN HOSE Ø 29 mm L=2500 mm (WITH DRAIN PUMP)  
TUYAU DE VIDEAGE Ø 29 mm L=2500 mm (AVEC POMPE DE VIDEAGE)  
TUBO DE DESAGUE Ø 29 mm L=2500 mm (CON POMPA DE DESAGUE)

Ⓔ	Min 10°C-MAX 50°C
Ⓔ	Min 10°C-MAX 25°C with ENERGY RECOVERY
Ⓔ	200÷500kPa(2÷5 Bar)
Ⓔ	100÷500kPa(1÷5 Bar) with ATMOSPHERIC BOILER
Ⓔ	HARDNESS 5÷20f-2.8÷11'd