



GENERAL FEATURES

- Rack size 60x50 cm
- Gross weigh 160 Kg
- Washing cycle/racks/hour:
2'-4'-6'-9'/30-15-10-7
- Possibility of automatic start / stop of the washing cycle (with hood closing/opening)
- Bottom wash/rinse arm
- Wash pump: 1.300 W
- Boiler capacity: 11 lt
- Tank capacity: 40 lt
- Boiler heating element: 9,0 kw
- Tank heating element: 4,5 kw
- Water quantity per cycle: 2,5 lt
- Electronic controls LCD display
- Useful washing height: 420 mm
- Magnetic door microswitch
- Automatic water filling
- Double electric detergent and rinse dispenser
- Hot rinse
- Thermostop function
- Self-cleaning vertical pump
- PRS system (Atmospheric Boiler+Break tank)
- Green Function for energy saving
- Automatic end-of-day self cleaning of water

FILTRATION

- Stainless steel surface filter with collection basket
- Wash pump filter, easily removable

BODY

- AISI 304 stainless steel Body
- Double skinned body
- Preformed wash tank
- Spring hood lifting system
- Wash/rinse arms in s/s, easily removable
- Boiler in s/s AISI 304

EQUIPMENT AS GLASSWASHER

- 1 stainless steel rack 4 trays
- 1 utensil basket 60x50 cm
- 1 inlet hose (length 2 m)
- 1 drain hose (length 2,5 m)

OPTIONAL

- Drain pump
- Hot water filling
- HD version (P.Tot. 14,8 kW, 380-415V3N~ only)
- 60 Hz version
- Kit remote control system

ACCESSORIES FOR WATER TREATMENT

- Integrated water softener unit ("S" model)

ACCESSORIES

- Entry / exit tables in stainless steel
- Pre-wash tables in stainless steel
- Special baskets

INSTALLATION

- Use the screws of the feet and a spirit level to ensure that the machine is levelled

MAIN POWER SUPPLY

- The voltage of main power supply must be compatible with the rated voltage
- The machine must be connected to a suitable earth (ground) system
- Connect the machine power socket to the multi-pole wall switch provided

WATER SUPPLY CONNECTION

- A water softener must be installed if the water is hard
- The water pressure must be between 0.2MPa (2 bar), and, 0.5MPa (5 bar)
- The temperature of the water-supply must be between 10°C to 50°C

SPECIFICHE TECNICHE

- Voltage: **380-415V3N / 220-240V3~50Hz**
- Total power: **10,3 Kw**
- Amperage: **15 A / 26 A**
- Power cord supply size: **5x4 mmq**

UK-H 60E PRS

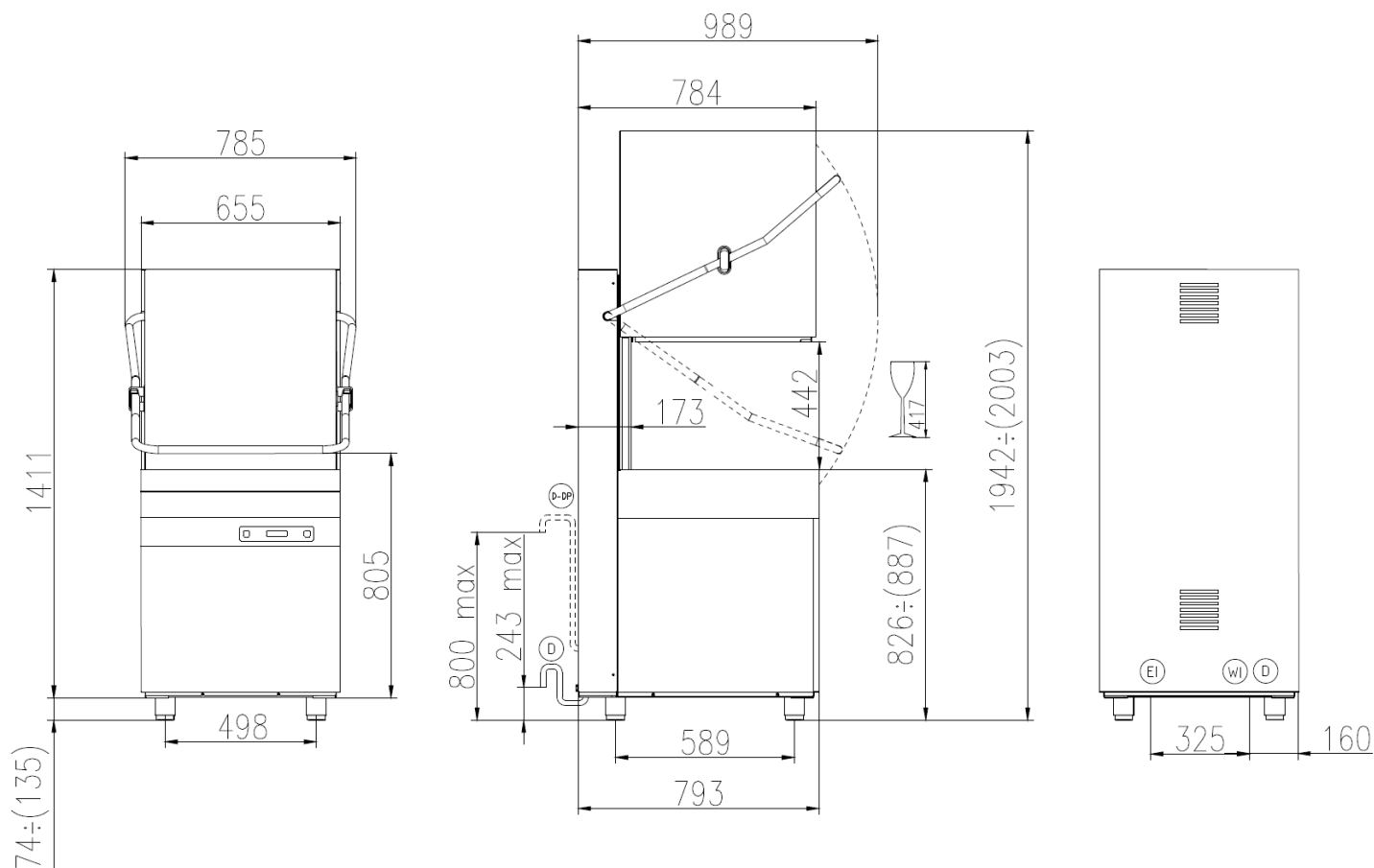

(EI)

CAVO DI ALIMENTAZIONE
POWER CORD SUPPLY
CABLE D'ALIMENTATION
CABLE DE ALIMENTACION

(WI)

CANNA DI CARICO G 3/4 L=2000 mm
G 3/4 INLET HOSE L=2000 mm
TUYAU D'ALIMENTATION G 3/4" L=2000 mm
TUBO DE ALIMENTACION G 3/4" L=2000 mm

(D)

TUBO DI SCARICO Ø 40 mm L=2000 mm
DRAIN HOSE Ø 40 mm L=2000 mm
TUYAU DE VIDANGE Ø 40 mm L=2000 mm
TUBO DE DESAGUE Ø 40 mm L=2000 mm

(D-DP)

TUBO DI SCARICO Ø 29 mm L=2500 mm (CON POMPA SCARICO)
DRAIN HOSE Ø 29 mm L=2500 mm (WITH DRAIN PUMP)
TUYAU DE VIDANGE Ø 29 mm L=2500 mm (AVEC POMPE DE VIDANGE)
TUBO DE DESAGUE Ø 29 mm L=2500 mm (CON POMPA DE DESAGUE)

Min 10°C-MAX 50°C
Min 10°C-MAX 25°C with ENERGY RECOVERY
200÷500kPa(2÷5 Bar)
100÷500kPa(1÷5 Bar) with ATMOSPHERIC BOILER
HARDNESS 5÷20f-2.8÷11'd