



GENERAL FEATURES

- Rack size 66x81.5 cm
- Gross weight: 260 Kg
- Washing cycle/racks/hour:
2'-3'-6'-9' / 30-20-10-7
- Stainless steel wash and rinse arms
- Wash pump: 2 Kw
- Boiler capacity: 11 liters
- Tank capacity: 65 liters
- Boiler heating element: 6 Kw
- Tank heating element: 6 Kw
- Water quantity per cycle: 3,5 liters
- Electronic controls LCD display
- Useful washing height: 650 mm
- Magnetic door microswitch
- Automatic water filling
- Double electric detergent and rinse dispenser
- Hot rinse
- Thermostop function
- Self cleaning vertical pump
- PRS system (Atmospheric Boiler+Break tank)
- ES system (Energy saving)
- Green Function for energy saving
- Automatic end-of-day self cleaning of water

FILTRATION

- Pre-filtering of the tank water by means of no. 1 stainless steel filter equipped with collection basket
- Pump filter in stainless steel, easily removable

BODY

- AISI 304 stainless steel Body
- Double skinned insulated body
- Door handle in s/s
- Preformed wash tank AISI 316
- Wash/rinse arms in s/s, easily removable
- Boiler in acciaio inox AISI 316

EQUIPMENT AS GLASSWASHER

- 1 inox basket 66x81.5 cm with wheels
- 1 inlet hose (length 2 m)
- 1 drain hose (length 2 m)

OPTIONAL

- Drain pump
- 60 Hz version
- HD version (P.Tot.17 kW, 380-415V3N ~ only)

ACCESSORIES FOR WATER TREATMENT

- External softener

ACCESSORIES

- Stainless steel supports for special tray washing cm. 60x80

INSTALLATION

- Use the screws of the feet and a spirit level to ensure that the machine is levelled

MAIN POWER SUPPLY

- The voltage of main power supply must be compatible with the rated voltage
- The machine must be connected to a suitable earth (ground) system
- Connect the machine power socket to the multipole wall switch provided

WATER SUPPLY CONNECTION

- A water softener must be installed if the water is hard
- The water pressure must be between 0.2MPa (2 bar), and, 0.5MPa (5 bar)
- The temperature of the water-supply must be between 10°C to 25°C

TECHNICAL SPECIFICATIONS

- Voltage: **380-415 V3N ~ 50 Hz**
- Total power: **11,0 kW**
- Amperage: **16 A**
- Power cord supply size: **5 x 4 mmq**

UK 65/65E ES

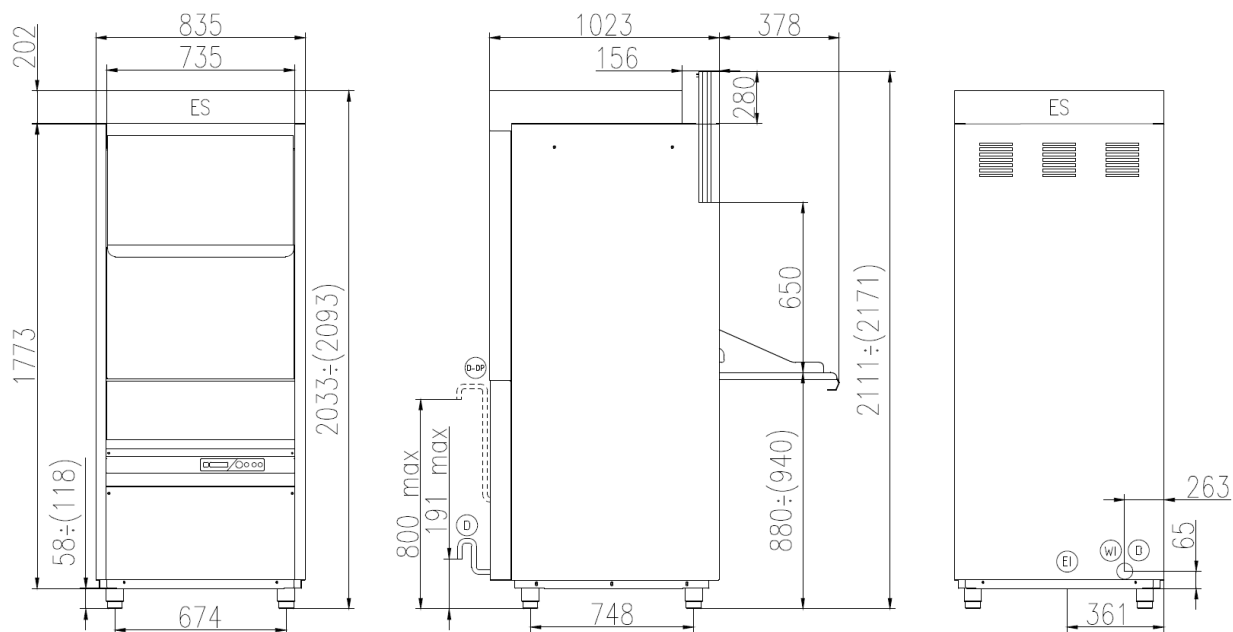

(EI) CAVO DI ALIMENTAZIONE
POWER CORD SUPPLY
CABLE D'ALIMENTATION
CABLE DE ALIMENTACION

(WI) CANNA DI CARICO G 3/4" L=2000 mm
G 3/4" INLET HOSE L=2000 mm
TUYAU D'ALIMENTATION G 3/4" L=2000 mm
TUBO DE ALIMENTACION G 3/4" L=2000 mm

(D) TUBO DI SCARICO Ø 40 mm L=2000 mm
DRAIN HOSE Ø 40 mm L=2000 mm
TUYAU DE VIDANGE Ø 40 mm L=2000 mm
TUBO DE DESAGUE Ø 40 mm L=2000 mm

(D-DP) TUBO DI SCARICO Ø 29 mm L=2500 mm (CON POMPA SCARICO)
DRAIN HOSE Ø 29 mm L=2500 mm (WITH DRAIN PUMP)
TUYAU DE VIDANGE Ø 29 mm L=2500 mm (AVEC POMPE DE VIDANGE)
TUBO DE DESAGUE Ø 29 mm L=2500 mm (CON POMPA DE DESAGUE)

| |
|---|
| Min 10°C-MAX 50°C |
| Min 10°C-MAX 25°C with ENERGY RECOVERY |
| 200÷500kPa(2÷5 Bar) |
| 100÷500kPa(1÷5 Bar) with ATMOSPHERIC BOILER |
| HARDNESS 5÷20°f-2.8÷11°d |