



#### GENERAL DETAILS

- Rack dimensions: **50x60 cm**
- Total weight: 159,5 Kg
- Washing cycles / racks/hour:  
60"- 120"-180"-9'/60-30-20-7
- Possibility of automatic start of washing cycle by closing the hood
- Upper and lower rotating wash/rinse arms with stainless steel tube
- Wash pump: 1.300 W
- Boiler capacity: 11 lt
- Tank capacity: 40 lt
- Boiler heating elements: 9,0 kw
- Tank heating elements 4,5 kw
- Water quantity per cycle: 2,5 lt
- Electronic controls with LCD display
- Useful washing height: 415 mm
- Magnetic hood microswitch
- Automatic filling of water
- Double electric detergent and rinse aid dispenser
- Hot rinse
- Thermostop function
- Vertical self-cleaning washing pump
- PRS system (Atmospheric Boiler+Break tank)
- Green function for energy saving
- Self-cleaning cycle at the end of the day

#### WATER FILTRATION

- Pre-filtering of tank water by means of no. 1 stainless steel filter
- Single wash pump filter, easily removable

#### BODY

- AISI 304 stainless steel body
- Preformed wash tank with rounded corners
- Single skin hood
- Hood opening system with springs
- Removable upper and lower wash/rinse arms for easy cleaning
- Boiler in AISI 316 stainless steel

#### EQUIPMENT

- 2 racks 50x60 cm, 22 plates
- 1 glass rack 50x60 cm
- 2 cutlery baskets
- 1 inlet hose (2 m lenght)
- 1 drain hose (2 m lenght)
- 

#### OPTIONALS

- Drain pump
- Hot water filling
- HD version (P.Tot. 14,8 kW, solo in 380-415V3N~)
- 60 Hz version
- Kit booster pump
- Kit remote control system

#### ACCESSORIES FOR WATER TREATMENT

- Integrated water softener unit ("S" model)

#### ACCESSORIES

- Entry / exit tables in stainless steel
- Pre-wash tables in stainless steel
- Special basket
- Special baskets

#### INSTALLATION

- Use the screws of the feet and a spirit level to ensure that the machine is levelled

#### MAIN POWER SUPPLY

- The voltage of main power supply must be compatible with the rated voltage
- The machine must be connected to a suitable earth (ground) system
- Connect the machine power socket to the multi-pole wall switch provided

#### WATER SUPPLY CONNECTION

- A water softener must be installed if the water is hard
- The water pressure must be between 0.2MPa (2 bar), and, 0.5MPa (5 bar)
- The temperature of the water-supply must be between 10°C to 50°C

#### TECHNICAL SPECIFICATIONS

- Voltage: **380-415V3N / 220-240V3~50Hz**
- Total power: **10,3 Kw**
- Amperage: **15 A /26 A**
- Power cord supply size: **5x4 mmq**

## HK 60E PRS

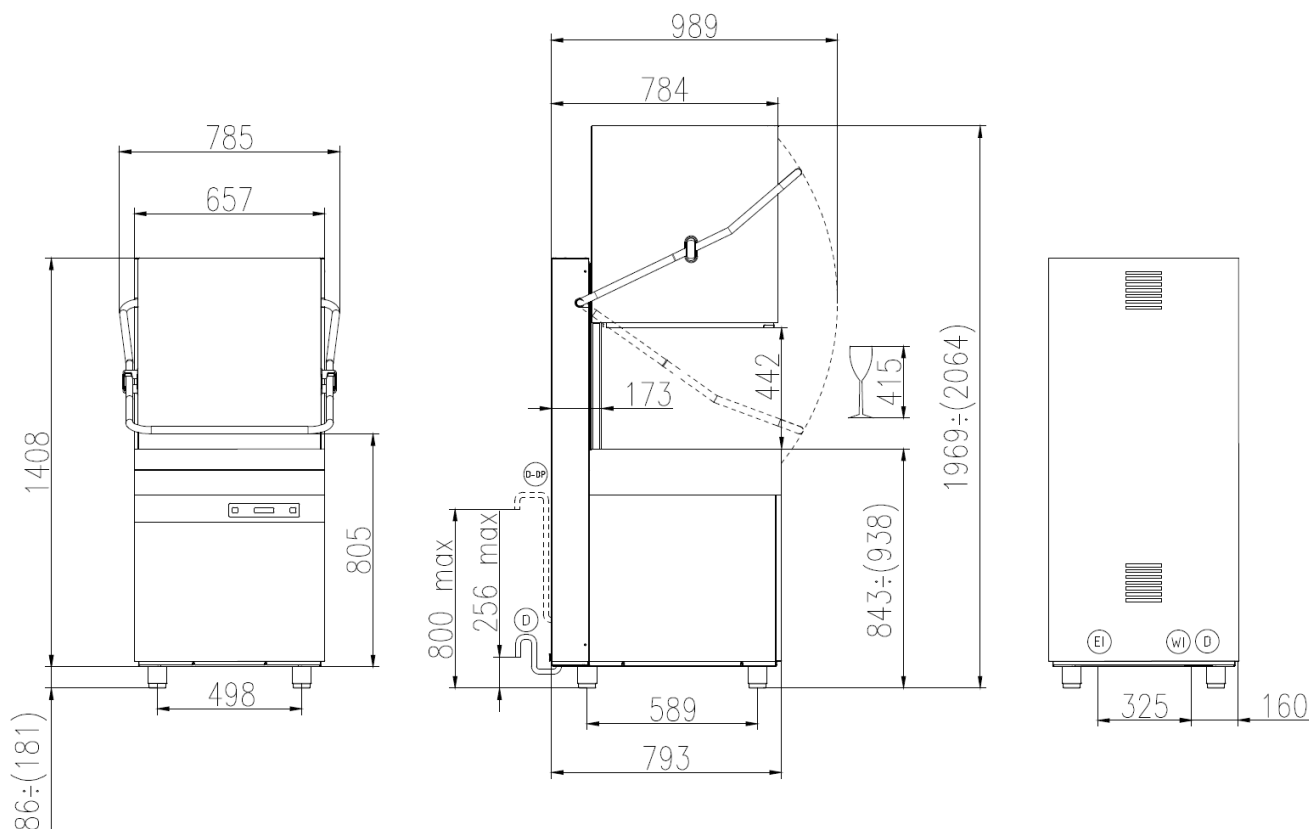

- EI** CAVO DI ALIMENTAZIONE  
POWER CORD SUPPLY  
CABLE D'ALIMENTATION  
CABLE DE ALIMENTACION
- WI** CANNA DI CARICO G 3/4 L=2000 mm  
G 3/4 INLET HOSE L=2000 mm  
TUYAU D'ALIMENTATION G 3/4" L=2000 mm  
TUBO DE ALIMENTACION G 3/4" L=2000 mm
- D** TUBO DI SCARICO Ø 40 mm L=2000 mm  
DRAIN HOSE Ø 40 mm L=2000 mm  
TUYAU DE VIDANGE Ø 40 mm L=2000 mm  
TUBO DE DESAGUE Ø 40 mm L=2000 mm
- D-DP** TUBO DI SCARICO Ø 29 mm L=2500 mm (CON POMPA SCARICO)  
DRAIN HOSE Ø 29 mm L=2500 mm (WITH DRAIN PUMP)  
TUYAU DE VIDANGE Ø 29 mm L=2500 mm (AVEC POMPE DE VIDANGE)  
TUBO DE DESAGUE Ø 29 mm L=2500 mm (CON POMPA DE DESAGUE)

Min 10°C-MAX 50°C
Min 10°C-MAX 25°C with ENERGY RECOVERY
200÷500kPa(2÷5 Bar)
100÷500kPa(1÷5 Bar) with ATMOSPHERIC BOILER
HARDNESS 5÷20°f-2.8÷11°d