



#### GENERAL DETAILS

Rack dimensions: **50x60 cm**

Total weight: 152,5 Kg

Washing cycles / racks/hour:

60"- 120"-180"-9'/60-30-20-7

Possibility of automatic start of washing cycle by closing the hood

Upper and lower rotating wash/rinse arms with stainless steel tube

Wash pump: 1.300 W

Boiler capacity: 8 lt

Tank capacity: 40 lt

Boiler heating elements: 9,0 kw

Tank heating elements: 4.5 kw

Water quantity per cycle: 2,5 lt

Electronic controls with LCD display

Useful washing height: 415 mm

Magnetic hood microswitch

Automatic filling of water

Double electric detergent and rinse aid dispenser

Hot rinse

Thermostop function

Vertical self-cleaning washing pump

Anti-Backflow system on the hydraulic circuit included

Green function for energy saving

Self-cleaning cycle at the end of the day

#### WATER FILTRATION

- Pre-filtering of tank water by means of no. 1 stainless steel filter
- Single wash pump filter, easily removable

#### BODY

- AISI 304 stainless steel body
- Single skin hood
- Preformed wash tank with rounded corners
- Hood opening system with springs
- Removable upper and lower wash/rinse arms for easy cleaning
- Boiler in AISI 304 stainless steel

#### EQUIPMENT

- 2 racks 50x60 cm, 22 plates
- 1 glass rack 50x60 cm
- 2 cutlery baskets
- 1 inlet hose (2 m lenght)
- 1 drain hose (2,5 m lenght)

#### OPTIONALS

- Drain pump
- Hot water filling
- HD Version (Total power 14,8 kW, 380-415V3N)
- 60 Hz Version
- Kit booster pump
- Kit remote control system

#### ACCESSORIES FOR WATER TREATMENT

- Integrated water softener unit ("S" model)

#### ACCESSORIES

- Entry / exit tables in stainless steel
- Pre-wash tables in stainless steel
- Special basket
- Special baskets

#### INSTALLATION

- Use the screws of the feet and a spirit level to ensure that the machine is levelled

#### MAIN POWER SUPPLY

- The voltage of main power supply must be compatible with the rated voltage
- The machine must be connected to a suitable earth (ground) system
- Connect the machine power socket to the multi-pole wall switch provided

#### WATER SUPPLY CONNECTION

- A water softener must be installed if the water is hard
- The water pressure must be between 0.2MPa (2 bar), and, 0.5MPa (5 bar)
- The temperature of the water-supply must be between 10°C to 50° C

#### TECHNICAL SPECIFICATIONS

- Voltage: **380-415V3N / 220-240V3~50Hz**
- Total power: **10,3 Kw**
- Amperage: **15 A /26 A**
- Power cord supply size: **5x4 mmq**

HK 60E

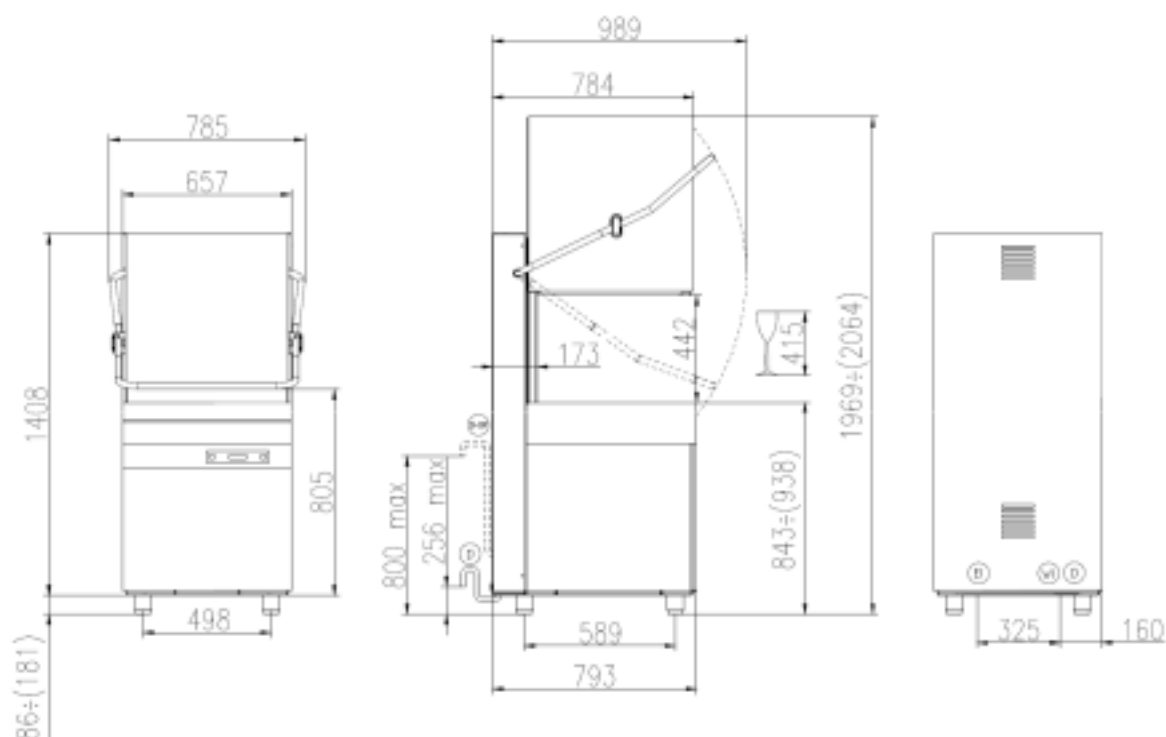

(EI) Cavo di alimentazione  
POWER CORD SUPPLY  
CABLE D'ALIMENTATION  
CABLE DE ALIMENTACION

(WI) DWRN DI CARICO 5 1/4" L=2000 mm  
5 1/4" RAIL HOSE L=2000 mm  
Tubo di carico/5/4" L=2000 mm  
TUBO DE CARGA 5 1/4" L=2000 mm

(D) TUBO DI SCARICO 40 mm L=2000 mm  
DRAIN HOSE 40 mm L=2000 mm  
TUBO DE VENTIL 40 mm L=2000 mm  
TUBO DE DESAGUE 40 mm L=2000 mm

(E-DP) TUBO DI SCARICO 25 mm L=2500 mm (CON POMPA SCARICO)  
DRAIN HOSE 25 mm L=2500 mm (WITH DRAIN PUMP)  
TUBO DE VENTIL 25 mm L=2500 mm (CON POMPA DE VENTIL)  
TUBO DE DESAGUE 25 mm L=2500 mm (CON POMPA DE DESAGUE)

Min. 10°C-Max. 30°C
Min. 10°C-Max. 30°C with DRAIN PUMP
Min. 10°C-Max. 30°C with DRAIN PUMP
Min. 10°C-Max. 30°C with DRAIN PUMP
Min. 10°C-Max. 30°C with DRAIN PUMP
Min. 10°C-Max. 30°C with DRAIN PUMP